



\$229,900

Ramblewood Subdivision

Rochester | School District | #3A

This 4BD, 2BA contemporary home has a walkout lower level and sits on a gorgeous 1.6 acre wooded lot. Updated kitchen and bath, walk-in closet, new kitchen flooring, new carpet and paint, HW floors, foyer entry, vaulted ceilings, family room with woodburner. Screened porch off kitchen and DR to take in the view. Attached 2.5c garage. All appliances stay.



Roni Mohan

Phone: 217-787-7215

Mobile: 217-899-7899

Email: ronimohan@yahoo.com

Web: <http://ronimohan.com>



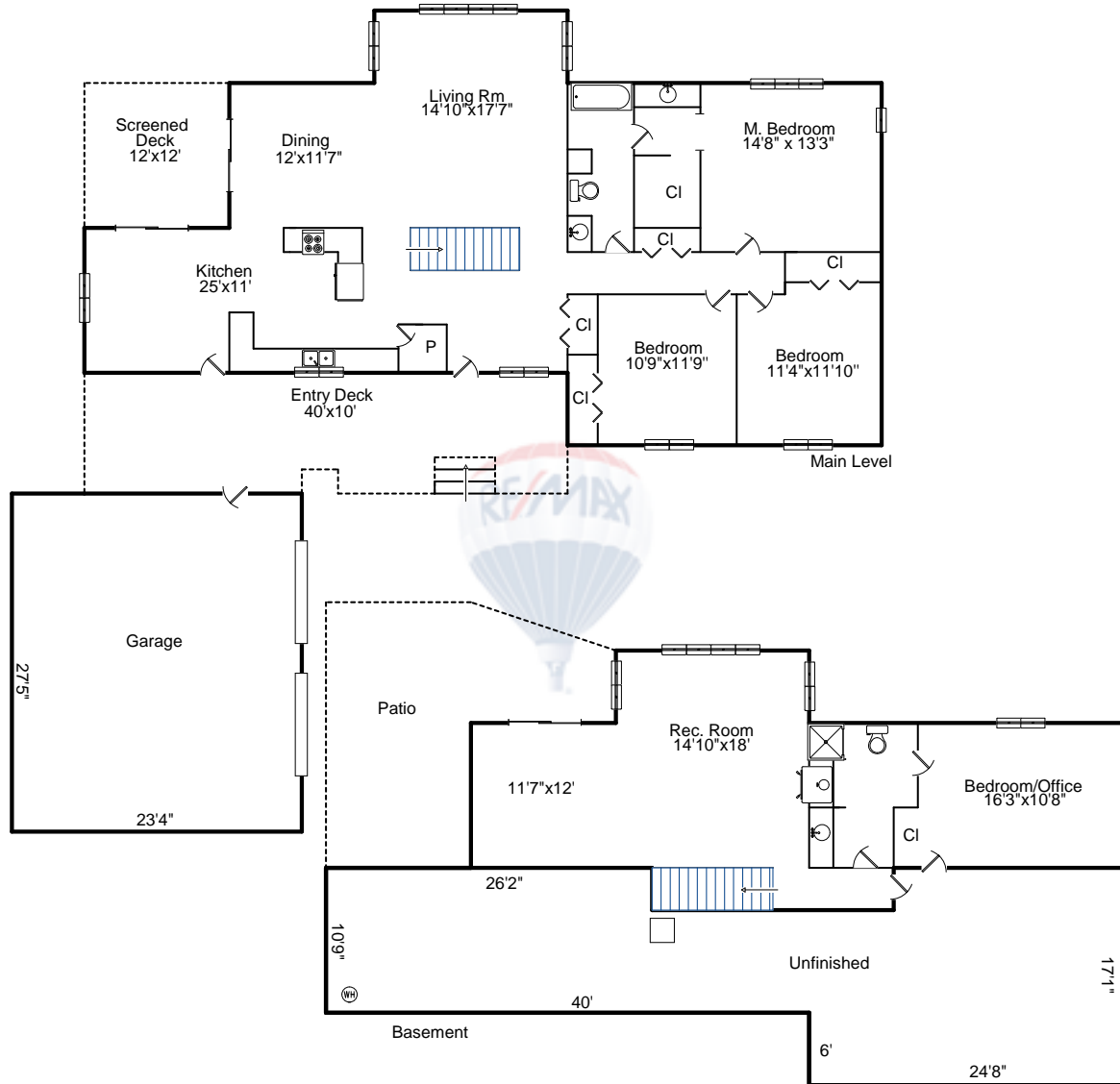

7215 Ramblewood Drive · Rochester IL 62563



RE/MAX Professionals

Roni Mohan

Office: 217-787-7215

Mobile: 217-899-7899

Email: ronimohan@yahoo.com

Web: <http://ronimohan.com>

Area:	Sq. Ft.
Main Level	1,692
Fin. Basement	814
Unf. Basement	878
Garage	672
Entry Deck	379
Patio	360
Screened Deck	144

